

Box Style Table Frame

Part No. 3842 512 566

Assembly Guide

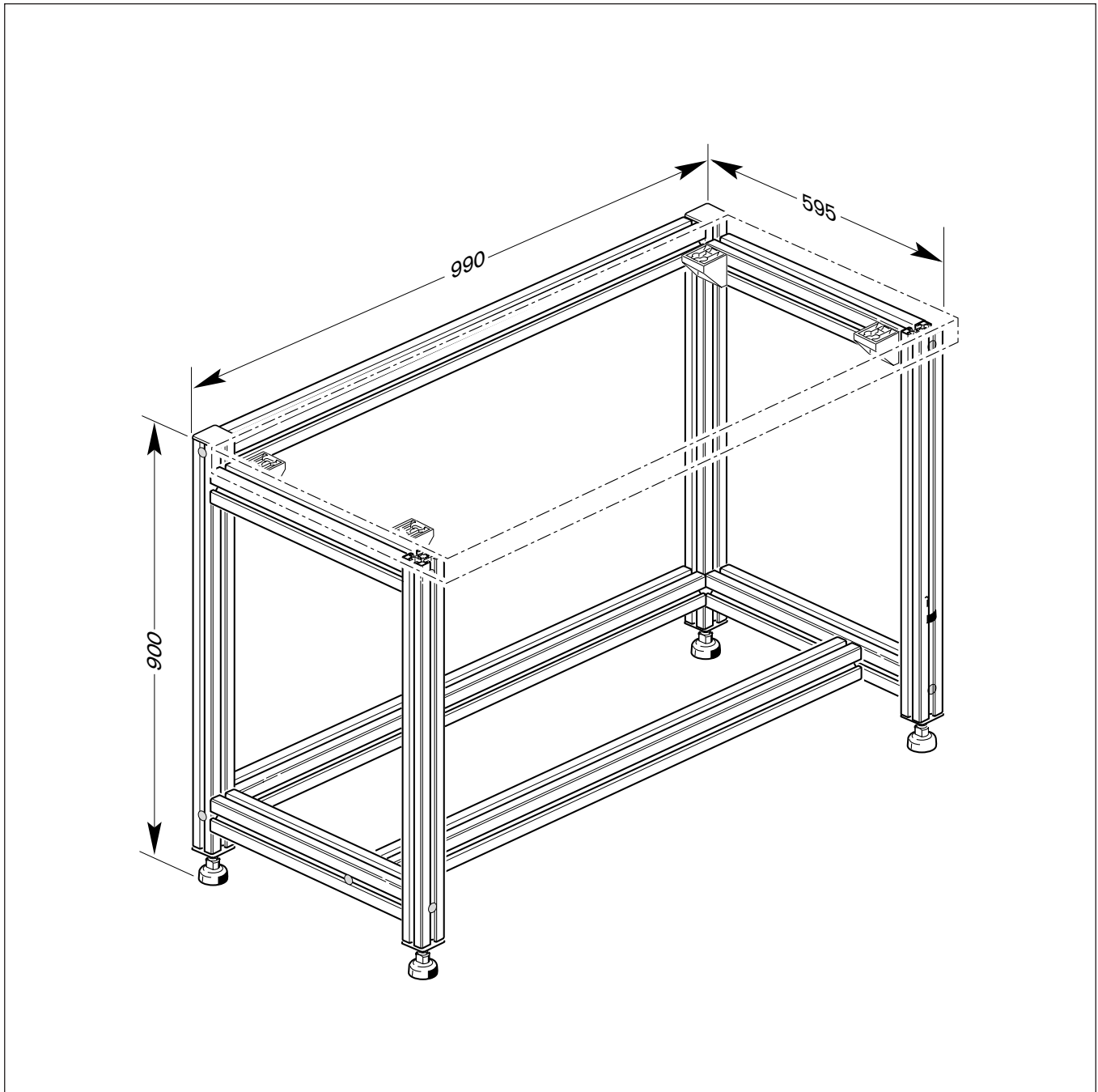
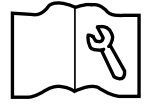

BOSCH

Automation Technology

SPECIFICATIONS

Box style frame part number	3842512566
Height	900 mm (35.43")
Width	990 mm (38.976")
Depth	595 mm (23.425")
Maximum load, centered	450 lbs. (2000 N)
Maximum load, distributed	900 lbs. (4000 N)

TOOLS REQUIRED

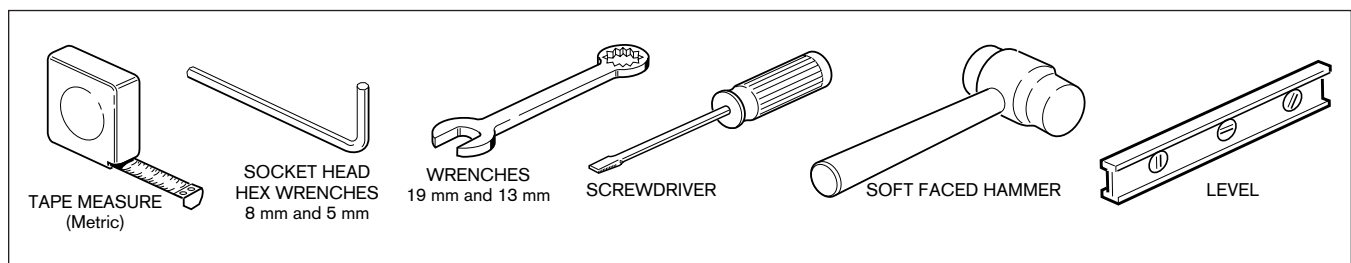

BEFORE YOU BEGIN

Before you begin to assemble the table, read through this manual to familiarize yourself with the assembly procedure. Check all parts carefully against the parts list on page 3. In some instances you may have extra hardware. The strut profiles can easily be identified by grouping them with one end even and then sorting them by length as shown in the parts list. Also the Bosch part number is attached to each profile for easy identification.

The adjacent drawing shows the location of each strut profile as it relates to the parts list. You may find it helpful to photo copy the parts list page and refer to it as you assemble the table.

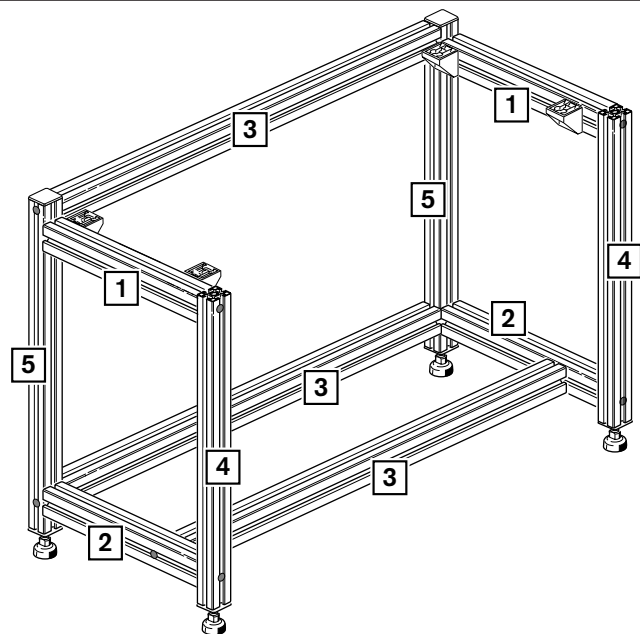

PARTS LIST

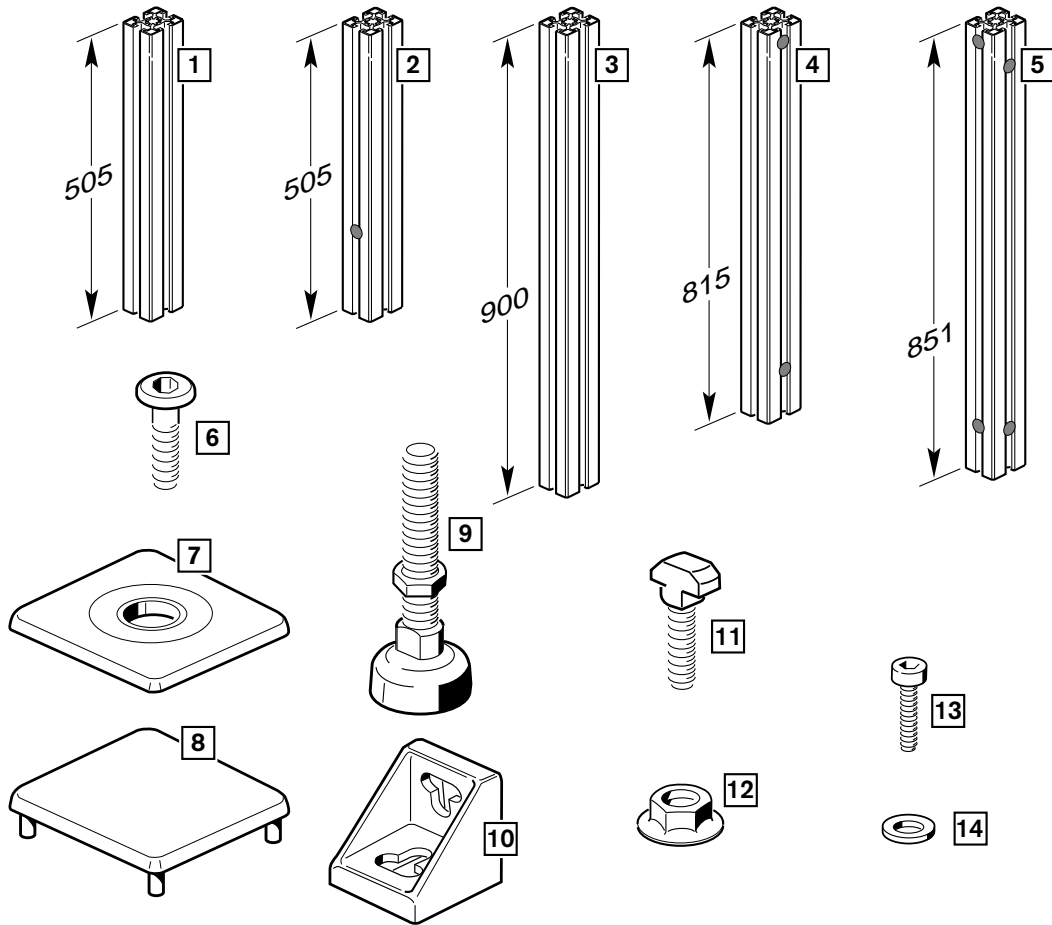

Key Number	Description	Quantity Needed	Part Number
[1]	505 mm x 45 x 45 strut profile	2	3842512550
[2]	505 mm x 45 x 45 strut profile	2	3842512549
[3]	900 mm x 45 x 45 strut profile	3	3842512558
[4]	815 mm x 45 x 45 strut profile	2	3842512554
[5]	851 mm x 45 x 45 strut profile	2	3842512556
[6]	S12 x 30 connection screw	14	3842511943
[7]	Leg cap, 45 x 45	4	3842502200
[8]	Upper profile cap, 45 x 45	6	3842502674
[9]	Leveling foot	4	3842352061
[10]	Gusset	4	3842348526
[11]	T-bolt, 25 mm	4	3842197091
[12]	Flange nut	4	3842345081
[13]	DIN7984 M8 x 30 LHCS	4	2910131246
[14]	DIN7349 M8 flat washer	4	2916201005

LEG SET ASSEMBLY

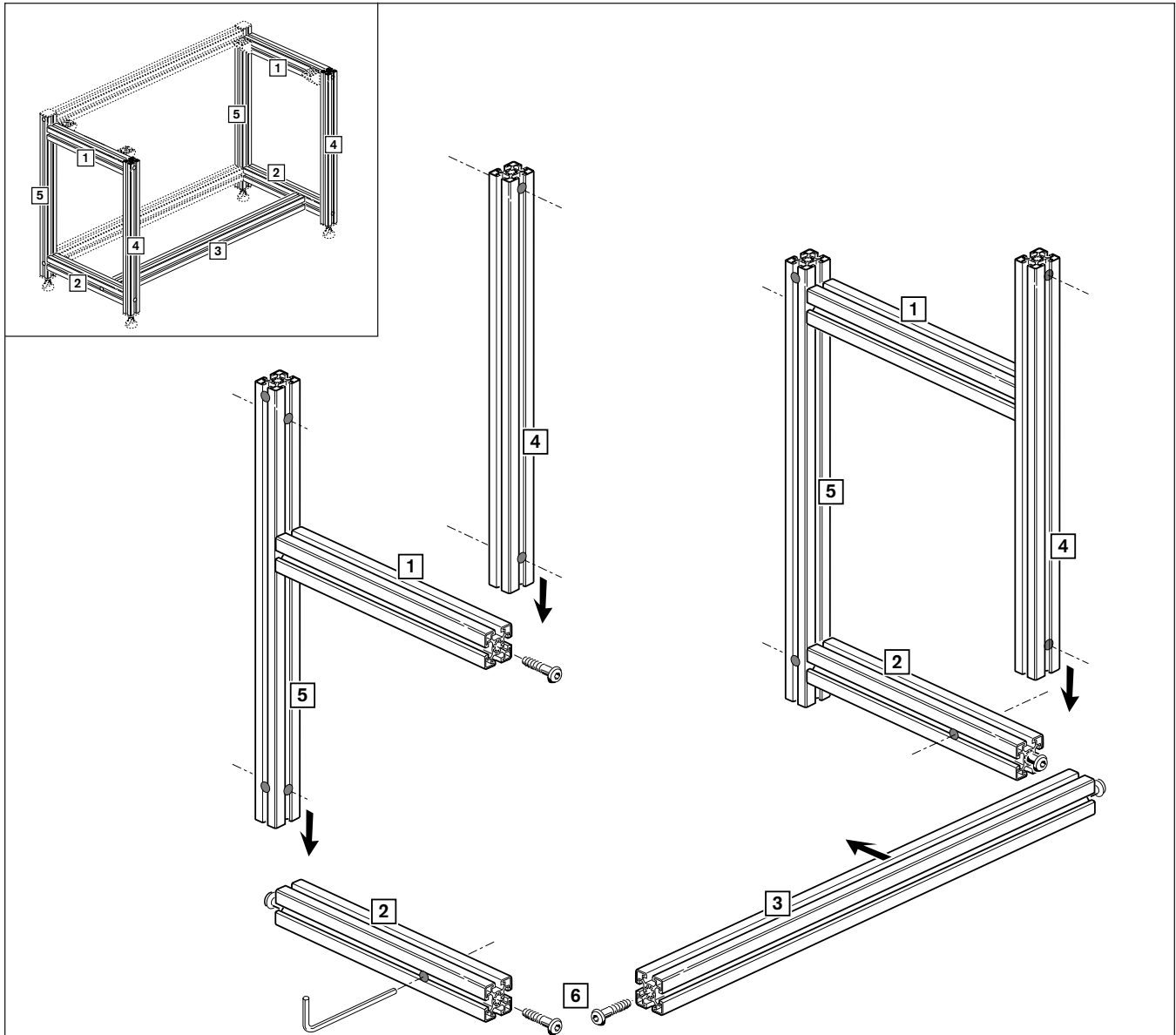

1 Install connection screws [6] into both ends of profiles [1], [2] and [3]. Turn the screw into the profile until the threads are completely inside the profile as shown below.

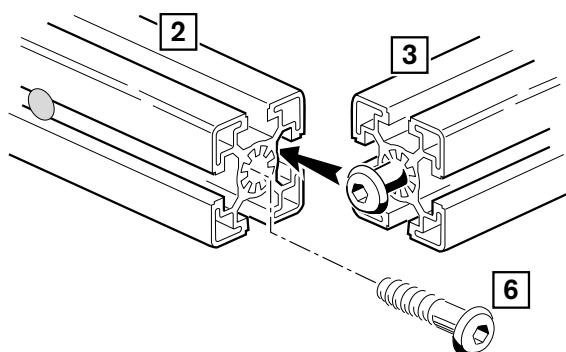

2 Slide profile [3] into position between profiles [2] and [3] and tighten the connection screw through the hole in the profile with an 8 mm socket head wrench.

3 Secure profile [5] to the back of the upper and lower profiles [1] and [2].

4 Connect profile [4] to the front of both upper and lower profiles [1] and [2]. Tighten all connector bolts to 35 Nm (25Ft/lbs).

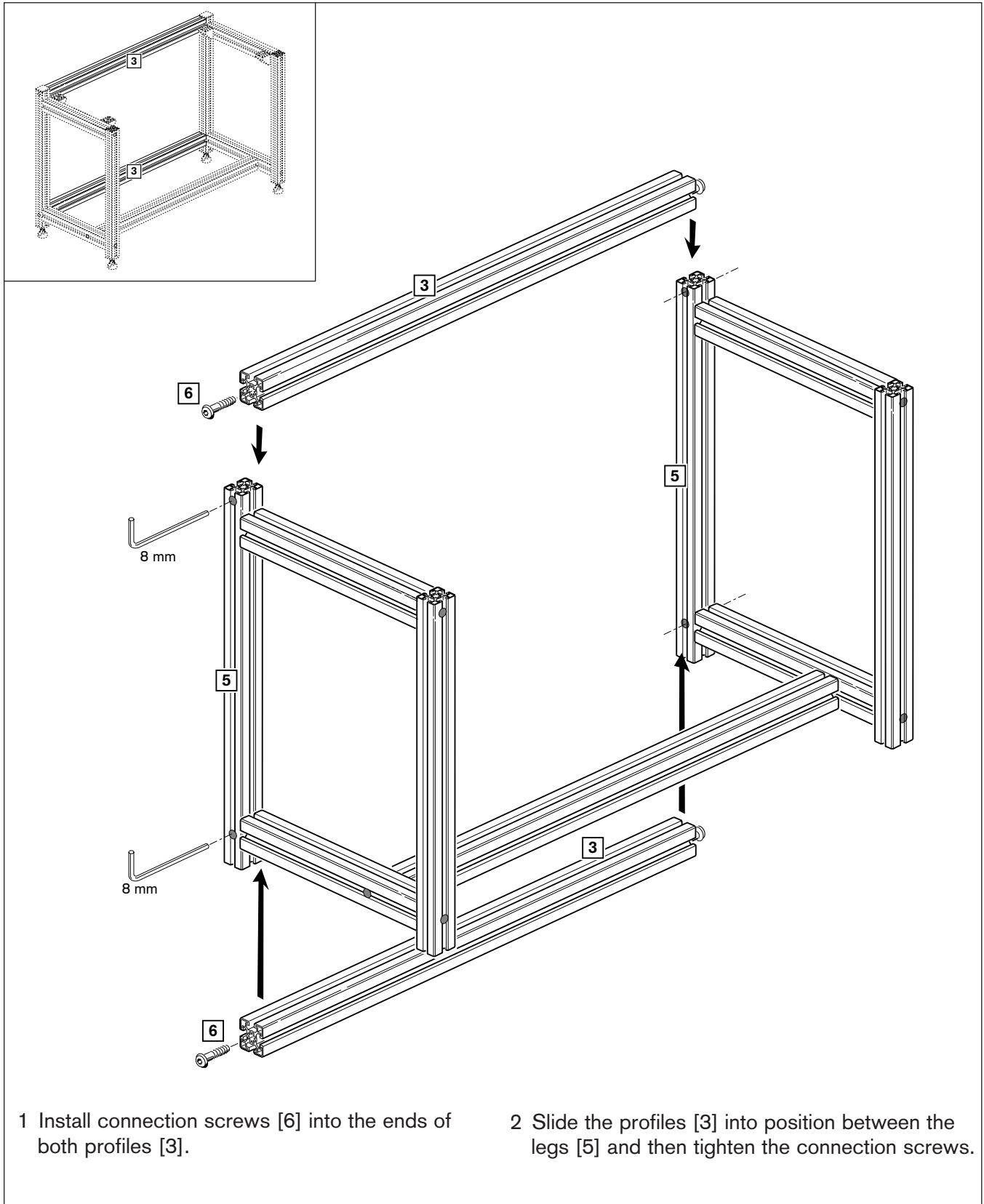
FRAME ASSEMBLY

FINAL ASSEMBLY

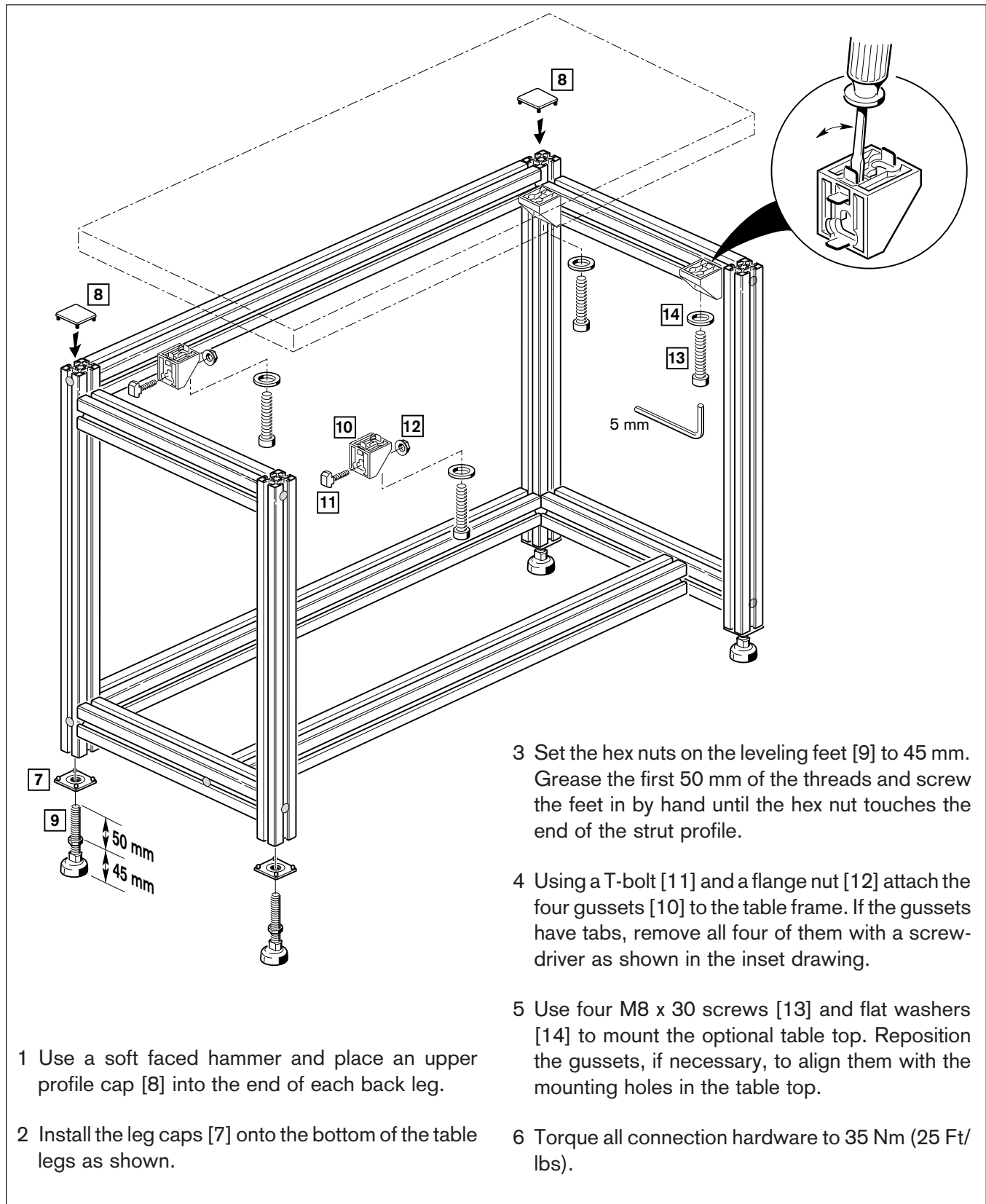

INSTALLATION

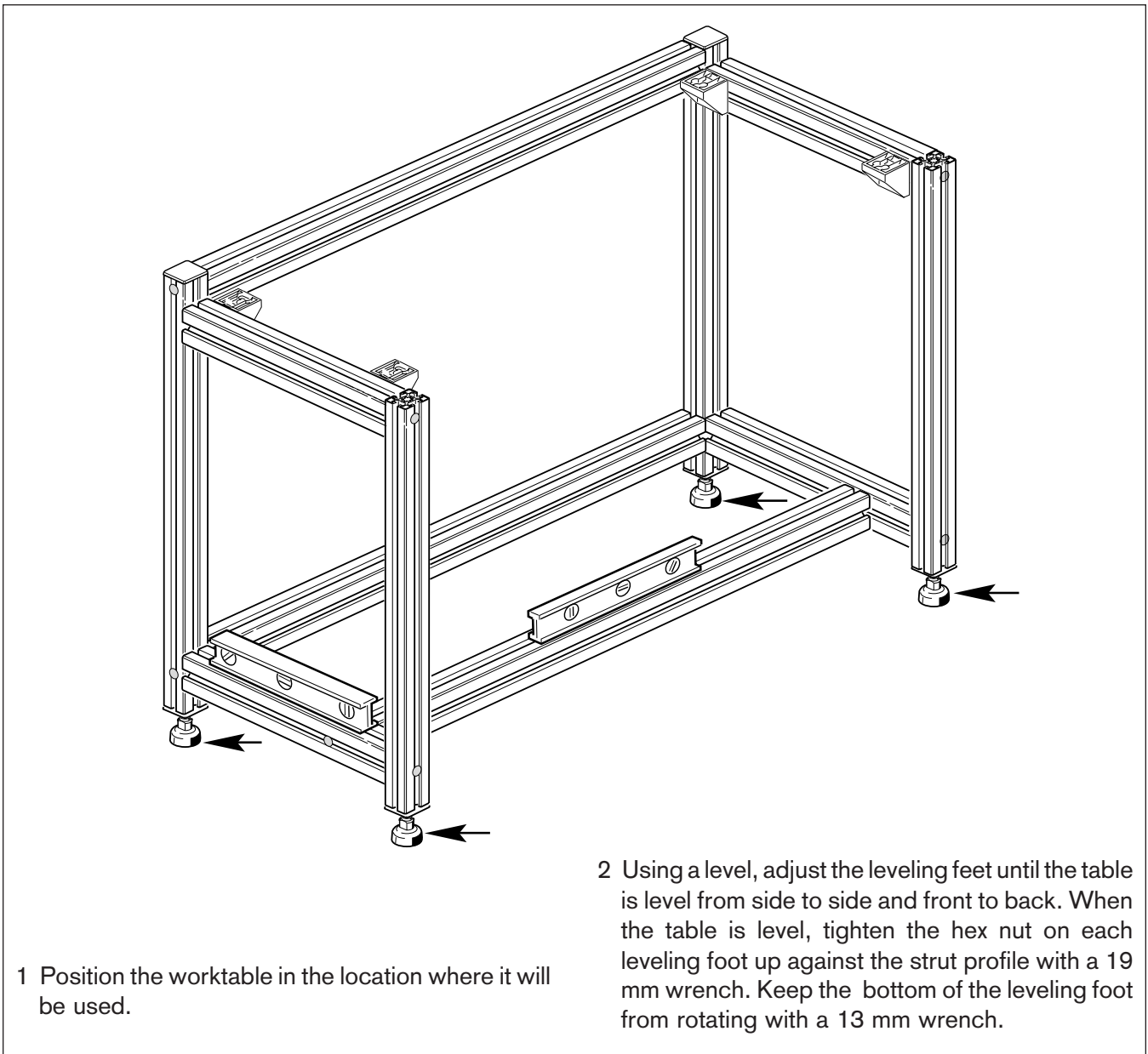

1 Position the worktable in the location where it will be used.

2 Using a level, adjust the leveling feet until the table is level from side to side and front to back. When the table is level, tighten the hex nut on each leveling foot up against the strut profile with a 19 mm wrench. Keep the bottom of the leveling foot from rotating with a 13 mm wrench.

BOSCH



All rights are held by BOSCH AUTOMATION PRODUCTS and ROBERT BOSCH GMBH, also regarding patent claims. We retain all powers of disposition, such as for copying and/or for passing-on to third parties.

We reserve the right to make technical changes at any time without notice.

Errors and omissions excepted.

© 1997 Bosch Automation Products

Bosch Automation Products

BOSCH Group

816 E. Third St.

Buchanan, MI 49107

Hot line: (800) 32-**BOSCH** [800-322-6724]

In Canada (800) 88-**BOSCH** [800-882-6724]

Tel.: (616) 695-0151

FAX: (616) 695-5363

8981 500 197 6/97